

# CASING HANGER / SECONDARY SEALS

Company

Services

CT Completions

CT Surface

CT Sub-Surface

CT Service Tools

Wellheads

Slickline

Engineering Data

Index

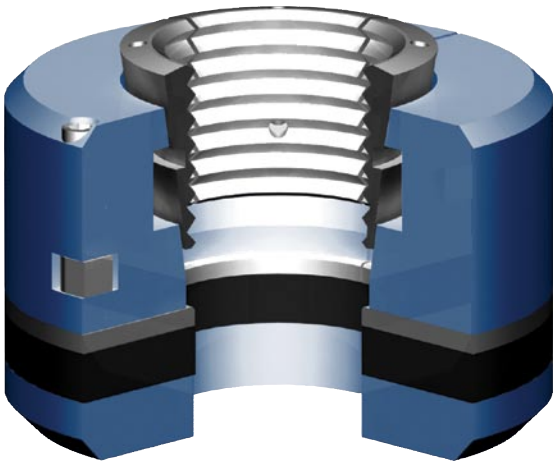

## Description

WC-22 automatic casing hangers (wrap around) incorporate a lower pack-off, slip bowl, and slips. The lower pack-off is energized by the weight of the casing which provides a positive annular seal.

## Features

- Heavy duty latch and hinge.
- Latch cap screw prevents accidental opening of hanger.
- Minimum number of parts.
- Pack-off is automatically energized with casing weight.



Flange Size	Casing Size	Approximate Weight (lbs)
11"	4 1/2"	100
11"	5"	95
11"	5 1/2"	89
11"	7"	75
11"	7 5/8"	60
13 5/8"	8 5/8"	125
13 5/8"	9 5/8"	108

The PE secondary seal is inserted in the bottom preparation of a casing spool or tubing spool and retained with a snap wire. The seal is energized when the spool is installed over the casing stub and the flange connection is made up.

The HPE secondary seal is designed for high-pressure applications. The bottom compression plate is threaded and is inserted into the bottom preparation of casing spools or tubing spools with threaded preparations.

Available in standard API casing sizes.