

THERMAL GRAPPLE CONNECTOR

Description

The Thermal Grapple Connector is a tool used for connecting Coiled Tubing to either surface or sub-surface equipment in high temperature environments. Using Graph-Oil packing the Thermal Grapple can withstand temperatures of 400°F.

Applications

- SAGD.
- High Temperature Wellbores.

Features & Benefits

- High temperature graph-oil packing.
- Able to handle large weight of Coiled Tubing.
- Thru bore to match coiled tubing ID providing no impediment of flow.

Specifications

Coiled Tubing Sizes (in. / mm)	Tool OD (in. / mm)	Connection
1 (25.40)	2.250 (57.15)	Custom Sizes Available
1.25 (31.75)	2.475 (62.88)	
1.5 (38.10)	2.366 (60.10)	
1.75 (44.45)	2.975 (75.57)	
2 (50.80)	2.975 (75.57)	
2.375 (60.32)	3.600 (91.44)	

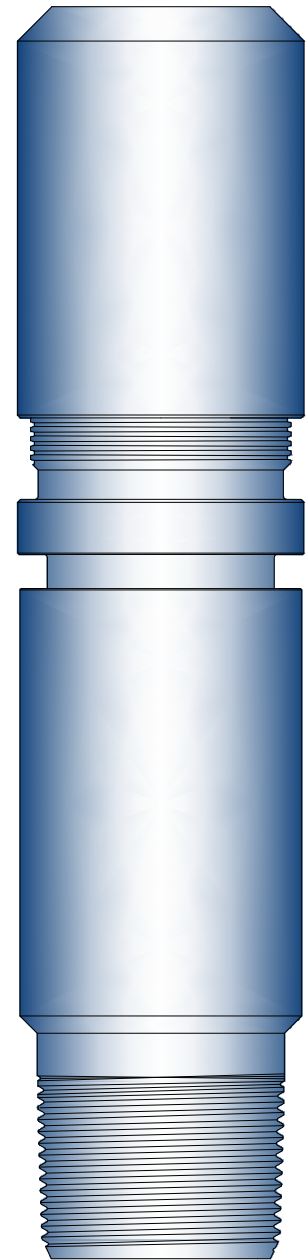

Company

Services

Wellheads

CT Completions

CT Surface

Sub-Surface

Service Tools